

Rampe droite ou courbe - poteaux INOX sur échelle bois ou métal

Exemple : Rampe courbe poteaux INOX sur échelle métal.

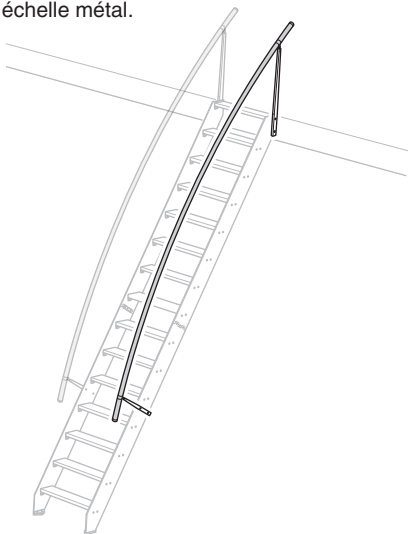

Exemple : Rampe droite poteaux INOX sur échelle bois.

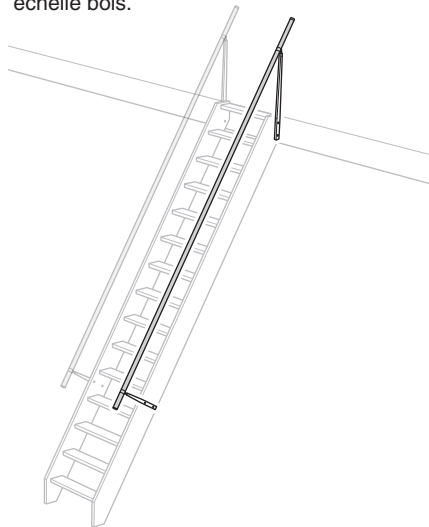

Rampe droite - poteaux ACIER sur échelle bois ou métal

Exemple : Rampe droite poteaux ACIER sur échelle métal.

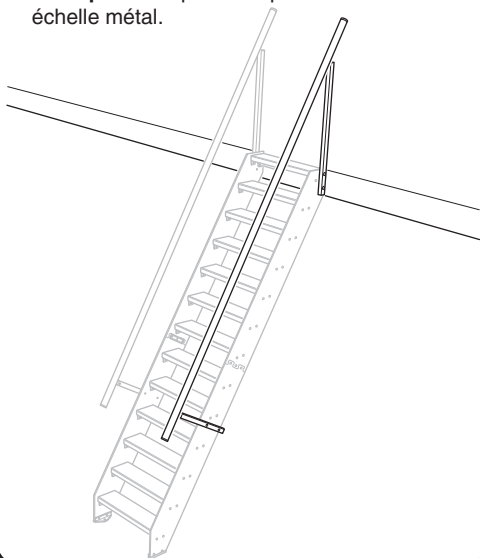

Exemple : Rampe droite poteaux ACIER sur échelle bois.

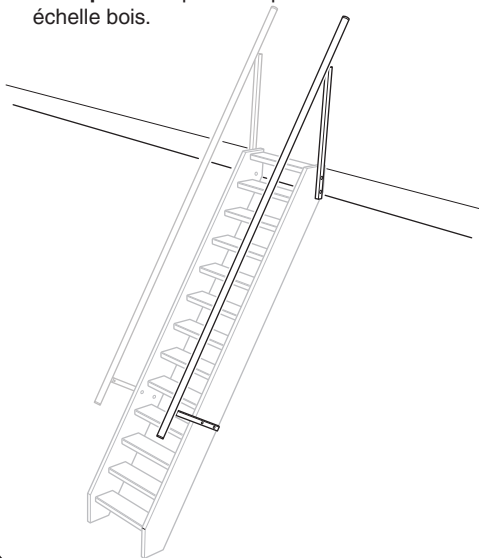

Colisage d'une rampe INOX

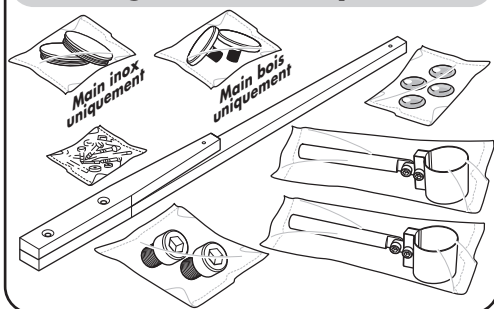

Colisage d'une rampe ACIER

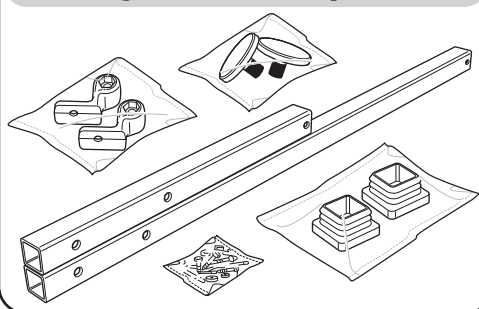

Accessoires fournis - rampe INOX

Échelle MÉTAL

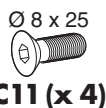

Échelle BOIS

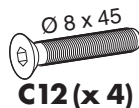

Accessoires fournis - rampe ACIER

Échelle MÉTAL

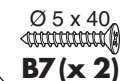

Échelle BOIS

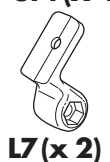
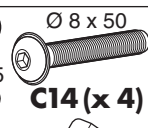

1h*

*à titre informatif la durée peut varier en fonction des configurations du chantier.

Conseils Préalables

- Porter des gants.



2 personnes

Outils nécessaires

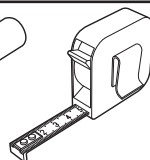
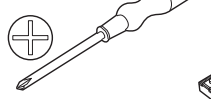
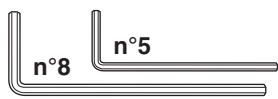
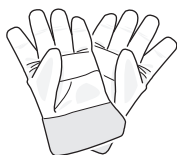

Pose des poteaux INOX

1 Pose du poteau haut

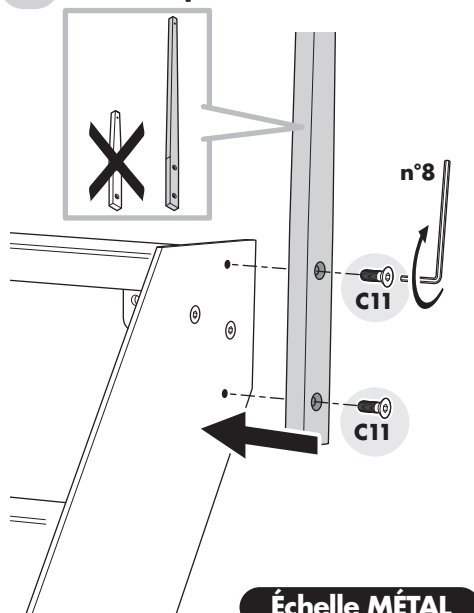

Échelle MÉTAL

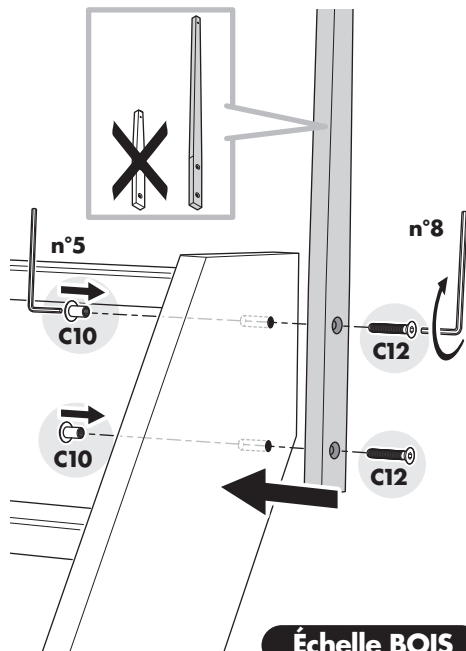

Échelle BOIS

2 Pose du poteau bas

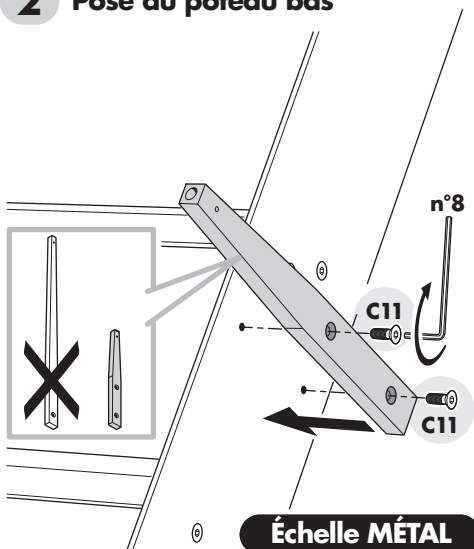

Échelle MÉTAL

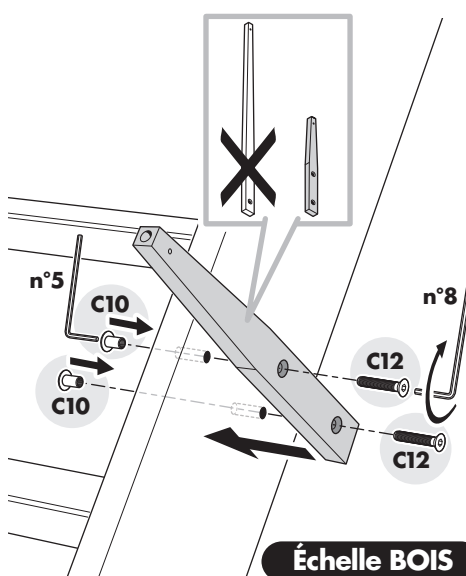

Échelle BOIS

Pose des poteaux ACIER

1 Pose du poteau haut

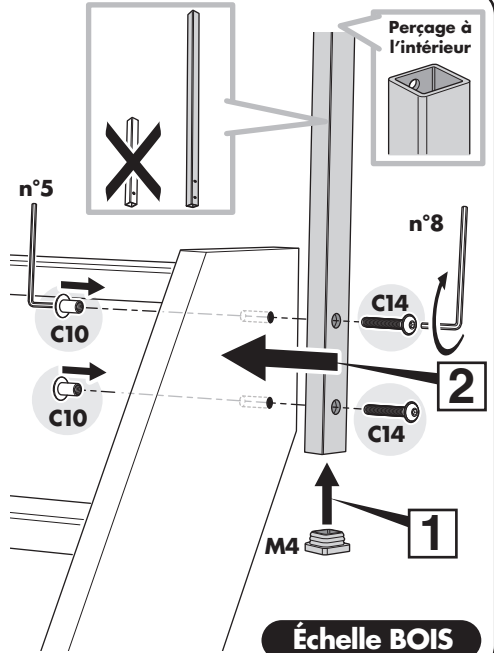
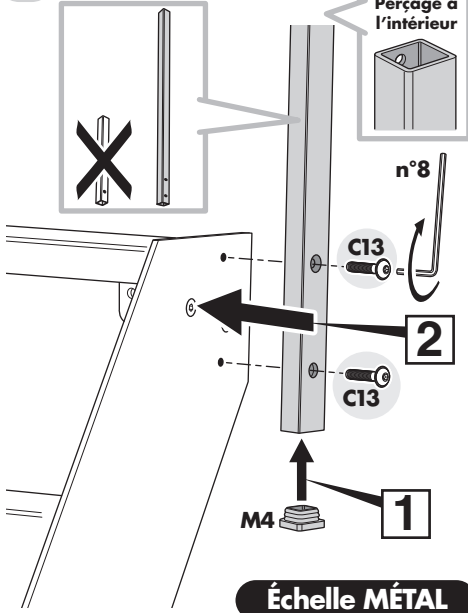

2 Pose du poteau bas

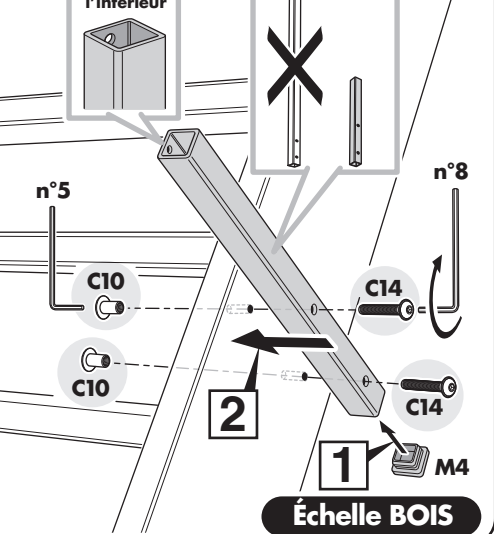
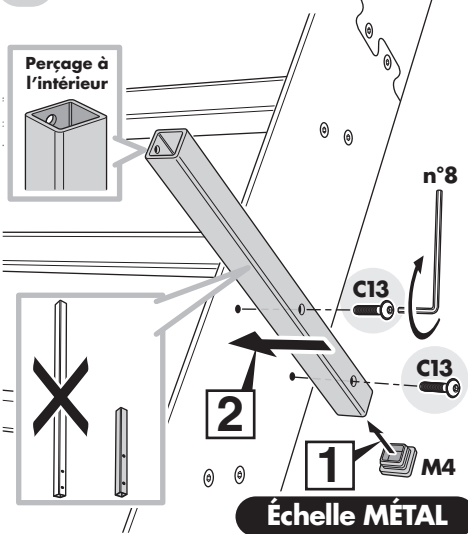

Pose des rampes sur poteaux INOX

1 Préparation des brides

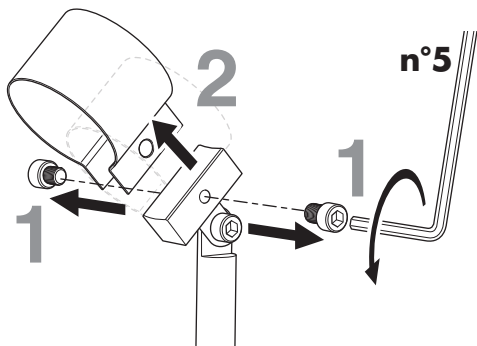

Pour main inox uniquement !

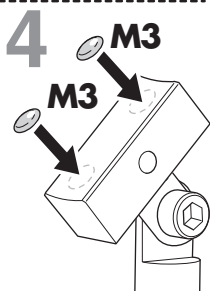

2 Fixation des brides

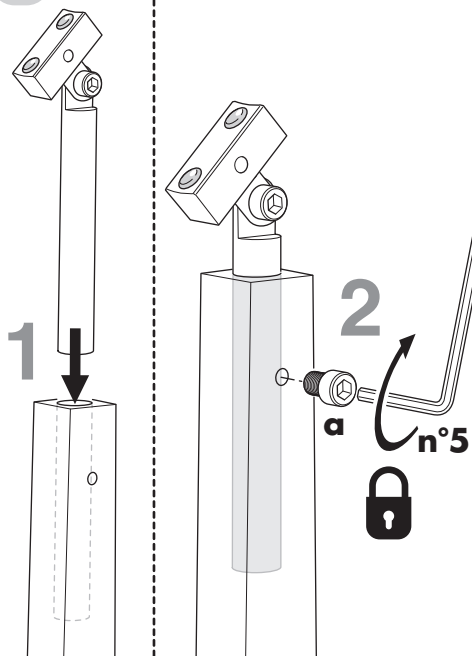

3 Insertion des brides sur la main courante.

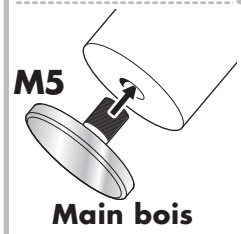
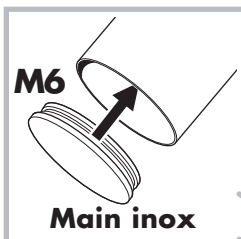

ATTENTION !
Risque de rayures
sur la main courante

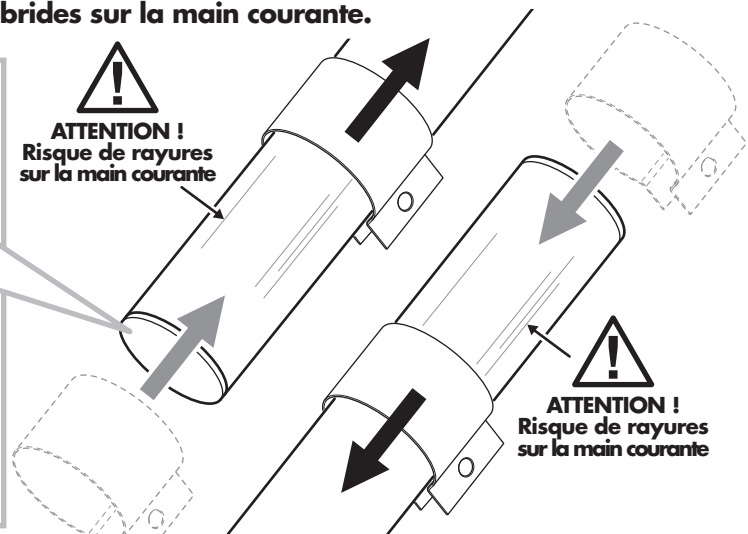

ATTENTION !
Risque de rayures
sur la main courante

4 Réglage et verrouillage.

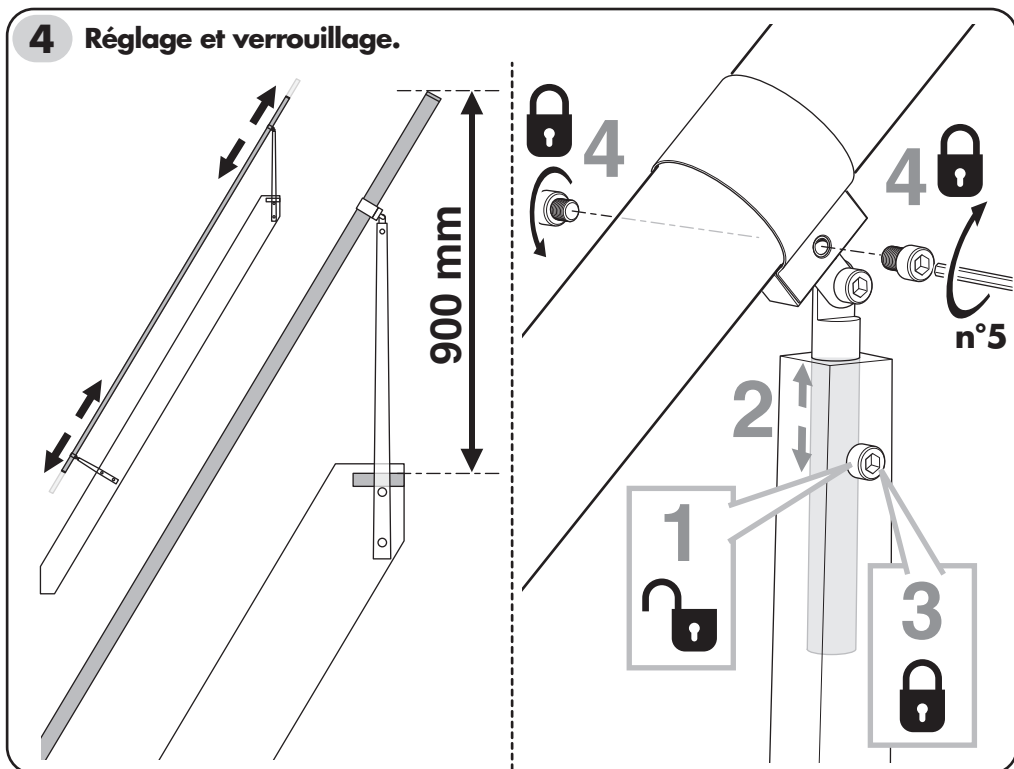

Pose des rampes sur poteaux ACIER

1 Fixation des rotules sur les poteaux ACIER.

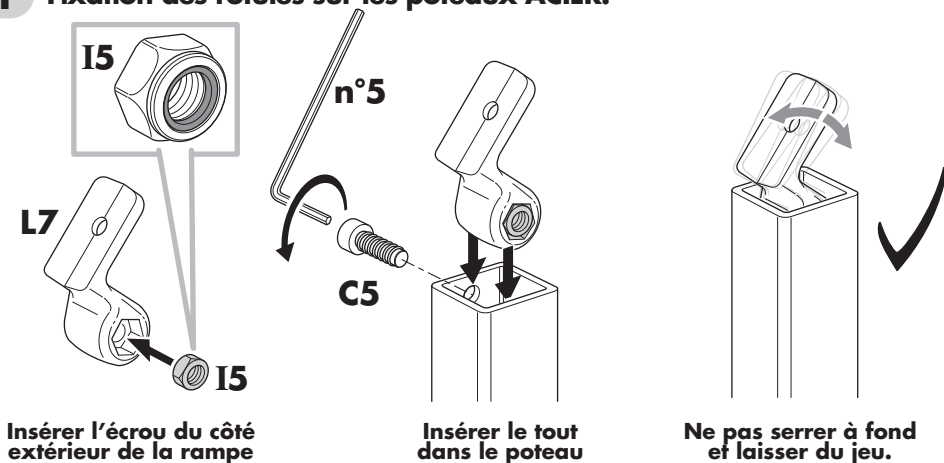

2 Préparation de la main courante.

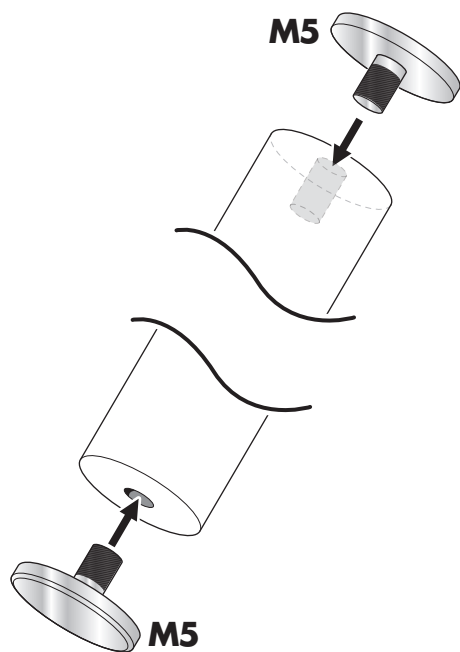

3 Fixation de la main courante.

